

## Shine4G-X User Manual

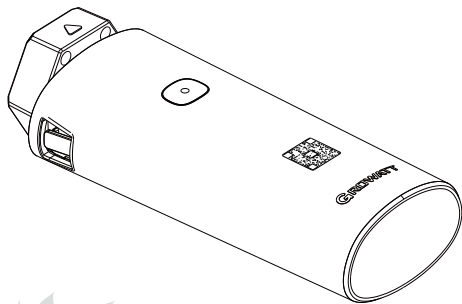

### 1. Product Overview

Shine4G-X is compatible with all on-grid inverters with USB port, which enables remote monitoring and maintenance of PV systems through 4G connection.

- Support mobile APP and server web page monitoring
- Support local commissioning and firmware upgrade
- Supports local data saving and break point retransmission

### 2. Product Appearance

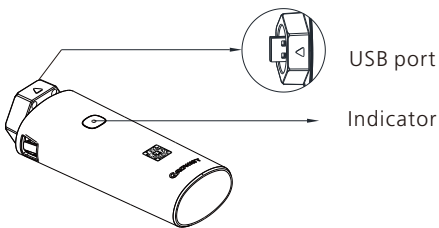

### 3. System Diagram

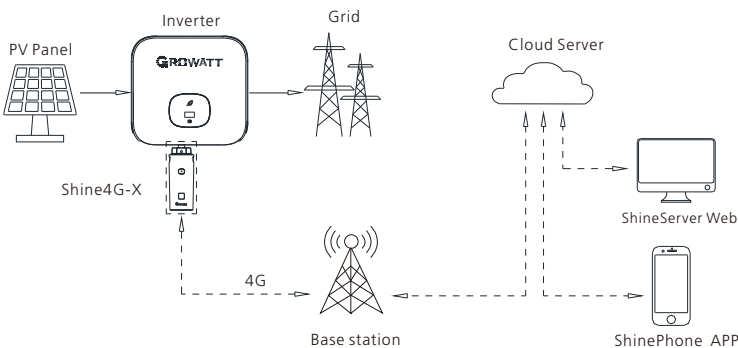

### 4. Installation and configuration

#### 4.1 SIM card installation

1. Use finger to press the hook on the both sides of datalogger, remove the top cover and circuit board from the main body case;
2. Gently press the SIM card until the SIM card is inserted into the card slot;
3. Put back the circuit board and top cover, when hear the "click" means the top cover fixed with main body.

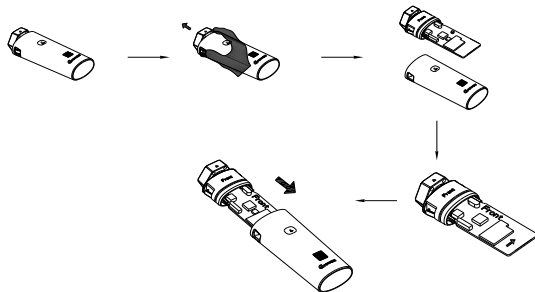

#### 4.2 Installation instructions

1. Rotate the USB cover of the photovoltaic device counterclockwise;
2. Rotate the datalogger locker on the upper, make sure the triangle is centered on the front;
3. Connect the datalogger to the inverter USB port, make sure the triangle is on the front side, press the locker and rotate clockwise until it is tighten.

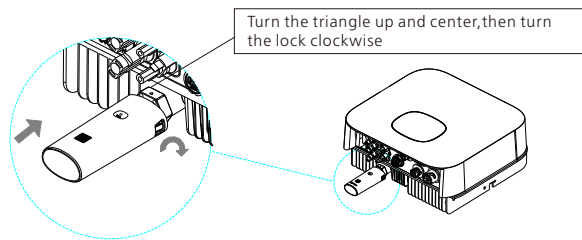

#### 4.3 Turn on inverter and check Shine4G-X state

After installing the Shine4G-X, turn on the inverter. When install the Shine4G-X for the first time, the indicate light will flash red. when the communication between server and inverter is established, it will flash blue. The following is the status description of LED lights:

LED Flashing status	Working status
LED off	Communication abnormal
Red LED flash	Communication with inverter is good and it is connecting to server now
Green LED flash	The communication with inverter is abnormal and the communication with server is good
Blue LED flash	Communication good

#### 4.3 Data logger configuration

1. Scan the QR code below to download ShinePhone, also you can search ShinePhone in Apple Store or Google Play, download and install it
2. After the APP is installed, you can follow the steps prompted on the APP interface to complete the datalogger configuration and build the PV plant. If there is any doubt in the configuration process, please refer to the 《Shine4G-X Configuration Guide》, which can be downloaded by scanning the QR code.



【ShinePhone APP】



【Shine4G-X Configuration Guide】

#### 4.5 Quick troubleshooting

LED status	Working status	Troubleshooting
Blue LED flash	Communication good	Normal working state
Red LED flash	Communication with inverter is good and it is connecting to server now	If the red light flash for a long time, please check if the domain name and the port information is right or not
Green LED flash	The communication with inverter is abnormal and the communication with server is good	Please check the connection between inverter and datalogger
Blue LED normally on	Datalogger abnormal	Change another datalogger
Red LED normally on	SIM card arrears or no signal	Check SIM card status
Green LED normally on	Failed to read SIM card	Check if the SIM card loose or damaged
LED off	Communication abnormal	1.Check connection between inverter and datalogger 2.Please check the domain name and the port information

#### 5. Specification

Type	Item	Parameter
General parameters	Dimensions(W/H/D)	47mm/122mm/32mm
	Weight	116g
	Manual language	Chinese、English
	Protection grade	IP65

4

Type	Item	Parameter
Electrical parameters	Data rate	USART:9600/115200bps
	Nominal voltage	5V (±5%)
	I <sub>max</sub>	2A
	Typical power consumption	5W
	Working temperature	-35°C ~ +65°C
	Storage temperature	-40°C ~ +70°C
Application parameters	Inverter communication	USB(Modbus RTU protocol)
	Server communication	TCP(Modbus TCP protocol)
	Supported servers	ShineServer
	Supported networks	2/3/4G
	User configuration Interface	APP configuration
	SIM card type	Common SIM card / Patch SIM card
	Data transmission interval	5Min
	Default server IP address	Server.growatt.com
Wireless parameters	Certificates	CE、UKCA、RoHS
	Wireless system type	4G
	GNSS	GNSS (GPS/GLONASS/BeiDou) Protocol:NMEA

5

Type	Item	Parameter
Wireless parameters	European version standard & frequency band	<ul style="list-style-type: none"><li>• TDD-LTE:B38/B40/B41</li><li>• FDD-LTE:B1/B3/B5/B7/B8/B20</li><li>• UMTS/HSPA+:B1/B5/B8</li><li>• GSM/GPRS:B3/B8</li></ul>
	South American version standard & frequency band	<ul style="list-style-type: none"><li>• TDD-LTE: B40</li><li>• FDD-LTE: B1/B2/B3/B4/B5/B7/B8/B28</li><li>• UMTS/HSPA+: B1/B2/B5/B8</li><li>• GSM/GPRS:850/900/1800/1900MHz</li></ul>
	Maximum output power	GSM/GPRS Power level: --EGSM900: 4 (2W) --DCS1800: 1 (1W) EDGE Power level: --EGSM900: E2 (0.5W) --DCS1800: E1 (0.4W) CDMA 1X Power level: 3 (0.25W) UMTS Power level: --WCDMA: 3 (0.25W) --EVDO: 3 (0.25W) --TD-SCDMA: 2 (0.25W) LTE Power level 3 (0.25W)
	Data rate	GPRS Multiple time slot levels 12 EDGE Multiple time slot levels 12 UMTS R99:384 kbps DL/UL HSPA+:5.76 Mbps(UL), 42 Mbps(DL) TD-HSDPA/HSUPA:2.2 Mbps(UL), 2.8 Mbps(DL) CDMA EVDO:Rev-0,Rev-A, Rev-B LTE Type 4 :150 Mbps (DL) LTE Type 4 :50 Mbps (UL)

6

#### 6. Declaration of conformity

This product complies with the following regulations and requirements:

- Electromagnetic Compatibility Directive:2014/30/EU (EMC)
- Radio equipment instruction:2014/53/EU(RED)
- Electrical Equipment (Safety) Regulations 2016:2014/35/EU(LVD)
- Restriction of Hazardous Substances Directive: 2011/65/EU(EU) and 2015/863 (RoHS)

You can download the Declaration of Compliance at <https://www.growatt.com>.

#### 7. After-sales service Contact

**Shenzhen Growatt New Energy CO.,LTD**  
4-13/F,Building A,Sino-German(Europe) Industrial Park,  
Hangcheng Ave, Bao'an District, Shenzhen, China

☎ +86 755 2747 1942  
✉ [service@ginverter.com](mailto:service@ginverter.com)  
🌐 [www.ginverter.com](http://www.ginverter.com)



Download  
Manual



Growatt New Energy

GR-UM-281-A-00

7